

## STEP 7 Starting Shaft Bearing Blocks

From parts bag 2: the Start Shaft Guide Blocks are pre-assembled. Slide the Starter Shaft through one of the block assemblies with the M5x11 Ball Bearing facing up then slide the M5 flat washer, spring and finally the M5x10 Collar

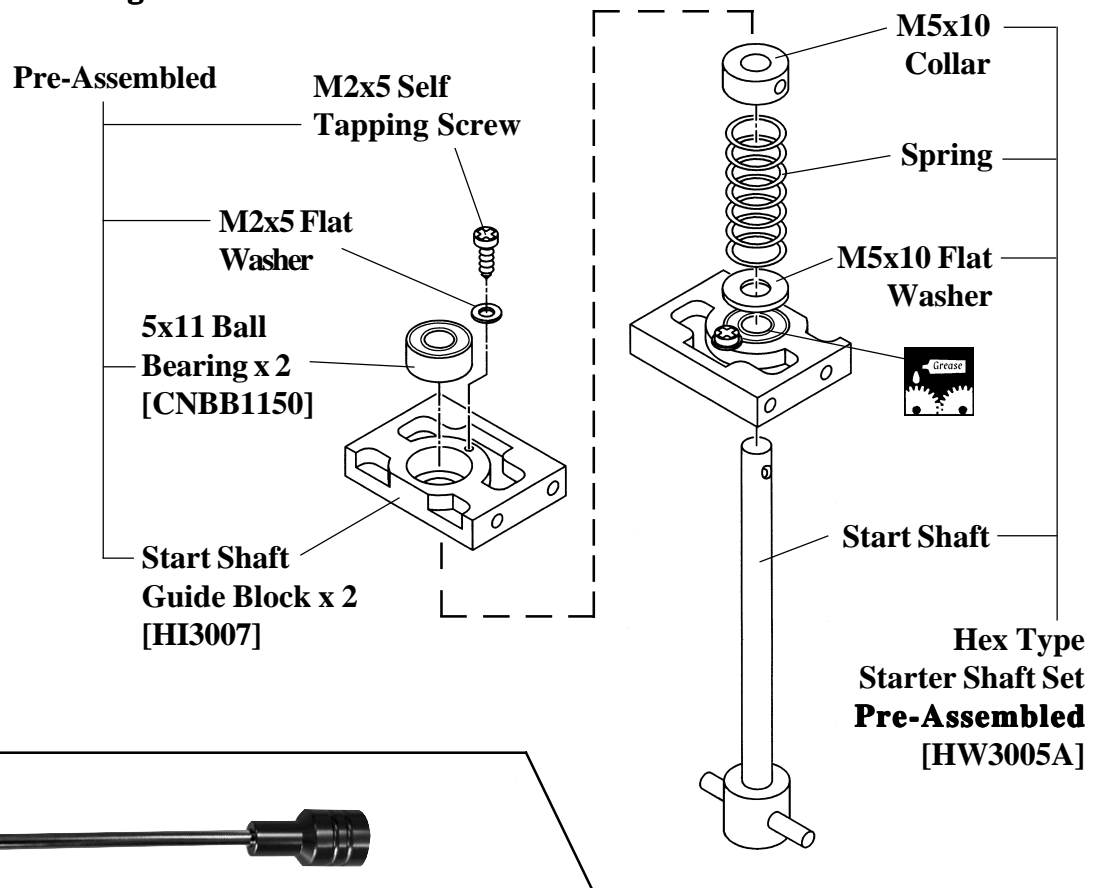

Hex Starter Extension (Optional Part#CN0426)

## STEP 8 Engine Start Shaft

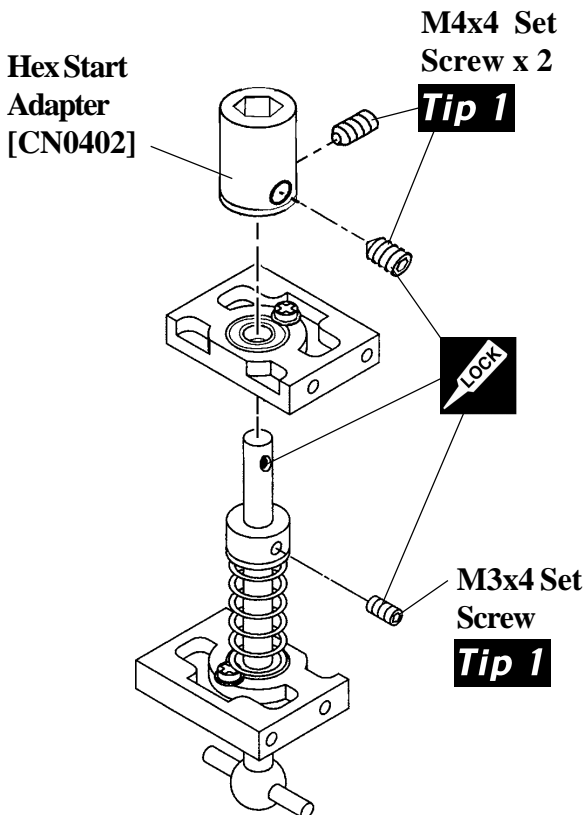

From parts in bag 2: After sliding the top bearing block in place, attach the hex start adapter to the starting shaft HW3005A using threadlock on both the shaft and the two M4x4 set screws. Align one set screw to fit into the machined indentation in the hardened start shaft. Apply some lubricant on the shaft after assembly to ensure smooth vertical movement inside the inner races of the bearings when engaging and disengaging of the start system.



When removing the hex start wand after the engine is started, it is recommended that you use a two step procedure.

- #1: Lift the hex wand upwards just enough to disengage the start system while keeping the wand inserted in the hex coupler (CN0402).
- #2: After the coupler has stopped turning, then remove the wand from the hex coupler.